



P R O D U C T D A T A S H E E T

USA/CA: brightonBEST.com Europe: brightonBEST.org AU: brightonBEST.com.au NZ: brightonBEST.co.nz Brazil: brightonBEST.com.br

Hexagon Socket Set Screws Cone Point - Inch Series

1.0 Dimensions: ASME B18.3.

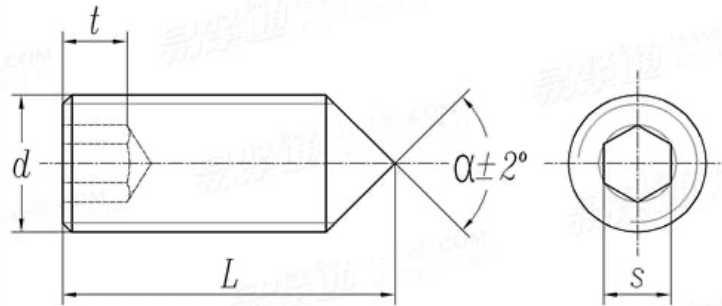

Nominal Size or Basic Product Diameter d	S	t	α	B
	Hexagon Socket Size	Key Engagement	Cone Point Angle 90 deg + or -2 deg for these nominal lengths or longer ; 118 deg + or - 2 deg for shorter lengths.	Shortest Optimum Nominal Length *
	Nom	Min	Nom	Nom
# 2	0.035	0.060	0.13	0.19
# 3	0.050	0.070	0.13	0.19
# 4	0.050	0.070	0.19	0.19
# 5	1/16	0.080	0.19	0.19
# 6	1/16	0.080	0.19	0.25
# 8	5/64	0.090	0.25	0.25
# 10	3/32	0.100	0.25	0.25
1/4	1/8	0.125	0.31	0.31
5/16	5/32	0.156	0.38	0.44
3/8	3/16	0.188	0.44	0.44
7/16	7/32	0.219	0.50	0.63
1/2	1/4	0.250	0.57	0.63
5/8	5/16	0.312	0.75	0.88
3/4	3/8	0.375	0.88	1.00

Notes: *For 90 Degree Cone Point Set Screws, minimum key engagement " t "is applicable only to nominal screw lengths equal to or longer than the lengths in column B. Thread Class of Fit: 3A.



BRIGHTON-BEST INTERNATIONAL



P R O D U C T D A T A S H E E T

USA/CA: brightonBEST.com Europe: brightonBEST.org AU: brightonBEST.com.au NZ: brightonBEST.co.nz Brazil: brightonBEST.com.br

Hexagon Socket Set Screws Cone Point - Inch Series

2.0 Mechanical Properties:

Set screws are subjected to compressive stress in applications. Tensile testing is not carried out on set screws.

2.1 Alloy Steel

Standard: ASTM F912

Hardness: HRC 45 to 53.

Hardness, Decarburization & Torsional strength test are the requisite mechanical properties to be met by the alloy steel socket set screws.

2.2 Stainless Steel

Standard: ASTM F880

Condition: CW

Hardness: 96 HRB to 33 HRC.

Hardness and Torsional strength test are the requisite mechanical properties to be met by the stainless steel socket set screws. Set screws (Stainless steel only) of sizes above 1/2 " are not subjected to torsional strength test.

The set screws will not have any markings.

3.0 Surface Finish:

Alloy Steel: Thermal Black Oxide Finish.

Stainless Steel: Passivated.



**BRIGHTON-BEST
INTERNATIONAL**



P R O D U C T D A T A S H E E T

USA/CA: brightonBEST.com Europe: brightonBEST.org AU: brightonBEST.com.au NZ: brightonBEST.co.nz Brazil: brightonBEST.com.br

Hexagon Socket Set Screws Cup Point - Inch Series

1.0 Dimensions: ASME B18.3.

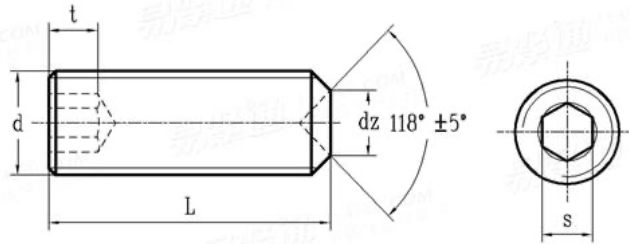

Nominal Size or Basic Product Diameter d	S	t	dz		B
	Hexagon Socket Size	Key Engagement	Point Diameter		Shortest Optimum Nominal Length*
	Nom	Min	Max	Min	Nom
# 0	0.028	0.050	0.033	0.027	0.13
# 1	0.035	0.060	0.040	0.033	0.13
# 2	0.035	0.060	0.047	0.039	0.13
# 3	0.050	0.070	0.054	0.045	0.19
# 4	0.050	0.070	0.061	0.051	0.19
# 5	1/16	0.080	0.067	0.057	0.19
# 6	1/16	0.080	0.074	0.064	0.19
# 8	5/64	0.090	0.087	0.076	0.19
# 10	3/32	0.100	0.102	0.088	0.19
1/4	1/8	0.125	0.132	0.118	0.25
5/16	5/32	0.156	0.172	0.156	0.31
3/8	3/16	0.188	0.212	0.194	0.38
7/16	7/32	0.219	0.252	0.232	0.44
1/2	1/4	0.250	0.291	0.270	0.50
5/8	5/16	0.312	0.371	0.347	0.63
3/4	3/8	0.375	0.450	0.425	0.75
7/8	1/2	0.500	0.530	0.502	0.88
1	9/16	0.562	0.609	0.579	1.00
1-1/8	9/16	0.562	0.689	0.655	1.25
1-1/4	5/8	0.625	0.767	0.733	1.25
1-3/8	5/8	0.625	0.848	0.808	1.50
1-1/2	3/4	0.750	0.926	0.886	1.50

Notes: *Minimum key engagement "t" is applicable only to nominal screw lengths equal to or longer than the lengths in column B. Thread Class of Fit: 3A.

Disclaimer: The above is a compilation of data, from various industry standards. BBI has taken every effort to present the data accurately. However BBI cannot be held liable for any claim traceable to any errors typographical or otherwise contained herein.



BRIGHTON-BEST INTERNATIONAL



P R O D U C T D A T A S H E E T

USA/CA: brightonBEST.com Europe: brightonBEST.org AU: brightonBEST.com.au NZ: brightonBEST.co.nz Brazil: brightonBEST.com.br

Hexagon Socket Set Screws Cup Point - Inch Series

2.0 Mechanical Properties:

Set screws are subjected to compressive stress in applications. Tensile testing is not carried out on set screws.

2.1 Alloy Steel

Standard: ASTM F912

Hardness: HRC 45 to 53.

Hardness, Decarburization & Torsional strength test are the requisite mechanical properties to be met by the alloy steel socket set screws.

2.2 Stainless Steel

Standard: ASTM F880

Condition: CW

Hardness: 96 HRB to 33 HRC.

Hardness and Torsional strength test are the requisite mechanical properties to be met by the stainless steel socket set screws. Set screws (Stainless steel only) of sizes above 1/2 " are not subjected to torsional strength test.

The set screws will not have any markings.

3.0 Surface Finish:

Alloy Steel: Thermal Black Oxide Finish.

Stainless Steel: Passivated.

Properties	Zinc Clear	Mechanical Zinc
Type	Trivalent (Cr+3)	Trivalent (Cr+3)
Color	Clear	Clear
Minimum Coating Thickness	0.0001" / 3 Microns	0.0003 " / 8 Microns
Specification	ASTM F1941 / F1941M. Fe/Zn 3AN	ASTM B695. Class 8. Type II.

Disclaimer: The above is a compilation of data, from various industry standards. BBI has taken every effort to present the data accurately. However BBI cannot be held liable for any claim traceable to any errors typographical or otherwise contained herein.



P R O D U C T D A T A S H E E T

USA/CA: brightonBEST.com Europe: brightonBEST.org AU: brightonBEST.com.au NZ: brightonBEST.co.nz Brazil: brightonBEST.com.br

Hexagon Socket Set Screws Flat Point - Inch Series

1.0 Dimensions: ASME B18.3.

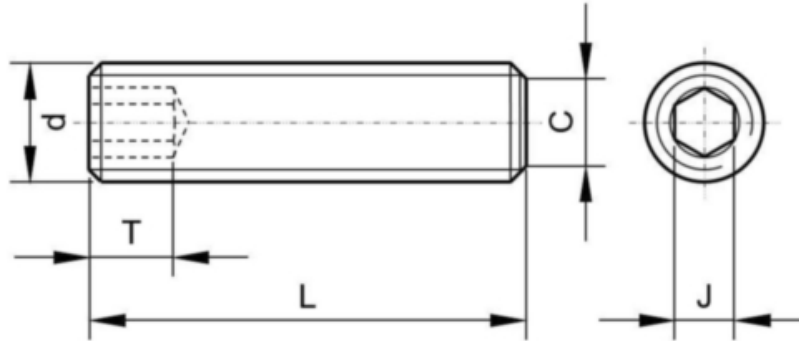

Nominal Size or Basic Product Diameter d	J	T	C		B
	Hexagon Socket Size	Key Engagement	Point Diameter		Shortest Optimum Nominal Length *
	Nom	Min	Max	Min	Nom
# 4	0.050	0.070	0.061	0.051	0.19
# 5	1/16	0.080	0.067	0.057	0.19
# 6	1/16	0.080	0.074	0.064	0.19
# 8	5/64	0.090	0.087	0.076	0.19
# 10	3/32	0.100	0.102	0.088	0.19
1/4	1/8	0.125	0.132	0.118	0.25
5/16	5/32	0.156	0.172	0.156	0.31
3/8	3/16	0.188	0.212	0.194	0.38
7/16	7/32	0.219	0.252	0.232	0.44
1 / 2	1/4	0.250	0.291	0.270	0.50
5/8	5/16	0.312	0.371	0.347	0.63
3 / 4	3/8	0.375	0.450	0.425	0.75

Notes: *Minimum key engagement “ T ” is applicable only to nominal screw lengths equal to or longer than the lengths in column B.

Thread Class of Fit: 3A.



BRIGHTON-BEST INTERNATIONAL



P R O D U C T D A T A S H E E T

USA/CA: brightonBEST.com Europe: brightonBEST.org AU: brightonBEST.com.au NZ: brightonBEST.co.nz Brazil: brightonBEST.com.br

Hexagon Socket Set Screws Flat Point - Inch Series

2.0 Mechanical Properties:

Set screws are subjected to compressive stress in applications. Tensile testing is not carried out on set screws.

2.1 Alloy Steel

Standard: ASTM F912

Hardness: HRC 45 to 53.

Hardness, Decarburization & Torsional strength test are the requisite mechanical properties to be met by the alloy steel socket set screws.

2.2 Stainless Steel

Standard: ASTM F880

Condition: CW

Hardness: 96 HRB to 33 HRC.

Hardness and Torsional strength test are the requisite mechanical properties to be met by the stainless steel socket set screws. Set screws (Stainless steel only) of sizes above 1/2 " are not subjected to torsional strength test.

The set screws will not have any markings.

3.0 Surface Finish:

Alloy Steel: Thermal Black Oxide Finish.

Stainless Steel: Passivated.



BRIGHTON-BEST INTERNATIONAL



P R O D U C T D A T A S H E E T

USA/CA: brightonBEST.com Europe: brightonBEST.org AU: brightonBEST.com.au NZ: brightonBEST.co.nz Brazil: brightonBEST.com.br

Hexagon Socket Set Screws Oval Point - Inch Series

1.0 Dimensions: ASME B18.3.

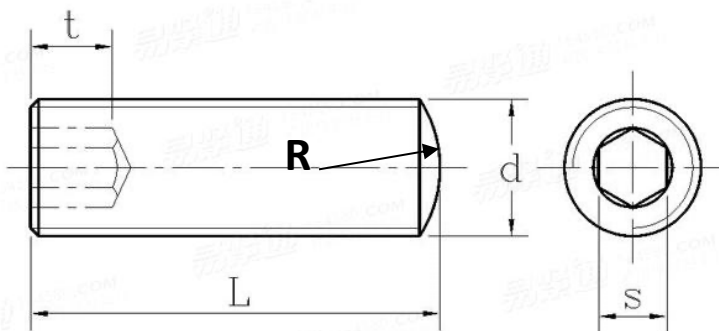

Nominal Size or Basic Product Diameter d	S	t	R	B
	Hexagon Socket Size	Key Engagement	Oval Point Radius	Shortest Optimum Nominal Length *
	Nom	Min	Basic	Nom
# 4	0.050	0.070	0.084	0.19
# 5	1/16	0.080	0.094	0.19
# 6	1/16	0.080	0.104	0.25
# 8	5/64	0.090	0.123	0.25
# 10	3/32	0.100	0.142	0.25
1/4	1/8	0.125	0.188	0.31
5/16	5/32	0.156	0.234	0.44
3/8	3/16	0.188	0.281	0.44
7/16	7/32	0.219	0.328	0.63
1/2	1/4	0.250	0.375	0.63
5/8	5/16	0.312	0.469	0.88
3/4	3/8	0.375	0.562	1.00

Notes: *Minimum key engagement “t” is applicable only to nominal screw lengths equal to or longer than the lengths in column B.

Thread Class of Fit: 3A.



BRIGHTON-BEST INTERNATIONAL



P R O D U C T D A T A S H E E T

USA/CA: brightonBEST.com Europe: brightonBEST.org AU: brightonBEST.com.au NZ: brightonBEST.co.nz Brazil: brightonBEST.com.br

Hexagon Socket Set Screws Oval Point - Inch Series

2.0 Mechanical Properties:

Set screws are subjected to compressive stress in applications. Tensile testing is not carried out on set screws.

2.1 Alloy Steel

Standard: ASTM F912

Hardness: HRC 45 to 53.

Hardness, Decarburization & Torsional strength test are the requisite mechanical properties to be met by the alloy steel socket set screws.

2.2 Stainless Steel

Standard: ASTM F880

Condition: CW

Hardness: 96 HRB to 33 HRC.

Hardness and Torsional strength test are the requisite mechanical properties to be met by the stainless steel socket set screws. Set screws (Stainless steel only) of sizes above 1/2 " are not subjected to torsional strength test.

The set screws will not have any markings.

3.0 Surface Finish:

Alloy Steel: Thermal Black Oxide Finish.

Stainless Steel: Passivated.



BRIGHTON-BEST INTERNATIONAL



P R O D U C T D A T A S H E E T

USA/CA: brightonBEST.com Europe: brightonBEST.org AU: brightonBEST.com.au NZ: brightonBEST.co.nz Brazil: brightonBEST.com.br

Hexagon Socket Set Screws Knurled Cup Point Inch Series

1.0 Dimensions: ASME B18.3.

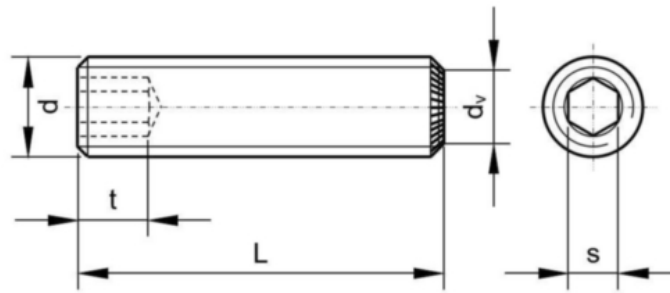

Nominal Size or Basic Product Diameter d	S	t	dv		B
	Hexagon Socket Size	Key Engagement	Point Diameter		Shortest Optimum Nominal Length *
	Nom	Min	Max	Min	Nom
# 4	0.050	0.070	0.061	0.051	0.19
# 5	1/16	0.080	0.067	0.057	0.19
# 6	1/16	0.080	0.074	0.064	0.19
# 8	5/64	0.090	0.087	0.076	0.19
# 10	3/32	0.100	0.102	0.088	0.19
1/4	1/8	0.125	0.132	0.118	0.25
5/16	5/32	0.156	0.172	0.156	0.31
3/8	3/16	0.188	0.212	0.194	0.38
7/16	7/32	0.219	0.252	0.232	0.44
1/2	1/4	0.250	0.291	0.270	0.50
5/8	5/16	0.312	0.371	0.347	0.63
3/4	3/8	0.375	0.450	0.425	0.75

Notes: *Minimum key engagement “ t ” is applicable only to nominal screw lengths equal to or longer than the lengths in column B.

Thread Class of Fit: 3A.

Disclaimer: The above is a compilation of data, from various industry standards. BBI has taken every effort to present the data accurately. However BBI cannot be held liable for any claim traceable to any errors typographical or otherwise contained herein.



BRIGHTON-BEST INTERNATIONAL



P R O D U C T D A T A S H E E T

USA/CA: brightonBEST.com Europe: brightonBEST.org AU: brightonBEST.com.au NZ: brightonBEST.co.nz Brazil: brightonBEST.com.br

Hexagon Socket Set Screws Knurled Cup Point Inch Series

2.0 Mechanical Properties:

2.1 Alloy Steel

Standard: ASTM F912

Hardness: HRC 45 to 53.

Set screws are subjected to compressive stress in applications. Tensile testing is not carried out on set screws. Hardness, Decarburization & Torsional strength test are the requisite mechanical properties to be met by the alloy steel socket set screws.

The set screws will not have any marking.

3.0 Surface Finish:

Thermal Black Oxide & Zinc Plating. Zinc plating as per details given in the table below:

Properties	Zinc Clear
Type	Trivalent (Cr+3)
Color	Clear
Minimum Coating Thickness	0.0001" / 3 Microns
Specification	ASTM F1941 / F1941M. Fe/Zn 3AN



P R O D U C T D A T A S H E E T

USA/CA: brightonBEST.com Europe: brightonBEST.org AU: brightonBEST.com.au NZ: brightonBEST.co.nz Brazil: brightonBEST.com.br

Hexagon Socket Set Screws Full Dog Point - Inch Series

1.0 Dimensions: ASME B18.3.

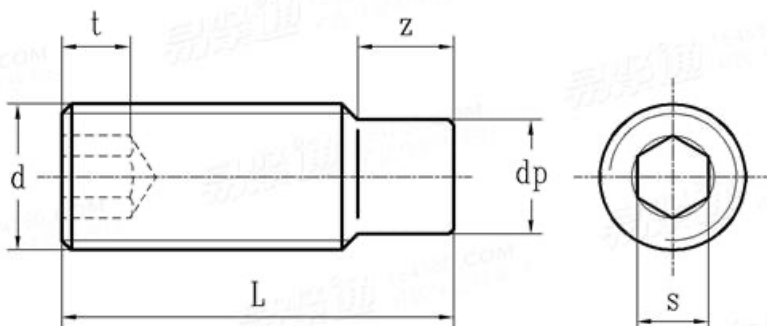

Nominal Size or Basic Product Diameter d	s	t	Full Dog Point Dimensions			
	Hexagon Socket Size	Key Engagement	Full Dog Point Diameter dp		Full Dog Point Length Z	
	Nom	Min	Max	Min	Max	Min
# 6	1/16	0.080	0.092	0.087	0.073	0.067
# 8	5/64	0.090	0.109	0.103	0.083	0.077
# 10	3/32	0.100	0.127	0.120	0.095	0.085
1/4	1/8	0.125	0.156	0.149	0.130	0.120
5/16	5/32	0.156	0.203	0.195	0.161	0.151
3/8	3/16	0.188	0.250	0.241	0.193	0.183
1/2	1/4	0.250	0.344	0.334	0.255	0.245
5/8	5/16	0.312	0.469	0.456	0.321	0.305

Notes: Full dog point dimensions are not covered in ASME B18.3. Full dog point diameter is exactly the same as that of the half dog point diameter. Full dog point length is almost double the half dog point length. For sizes #10 & above, the full dog point length is same as that of square head set screws full dog point length, given in the standard ASME B18.6.2.

Thread Class of Fit: 3A.



BRIGHTON-BEST INTERNATIONAL



P R O D U C T D A T A S H E E T

USA/CA: brightonBEST.com Europe: brightonBEST.org AU: brightonBEST.com.au NZ: brightonBEST.co.nz Brazil: brightonBEST.com.br

Hexagon Socket Set Screws Full Dog Point - Inch Series

2.0 Mechanical Properties:

Alloy Steel

Standard: ASTM F912.

Hardness: HRC 45 to 53.

Set screws are subjected to compressive stress in applications. Tensile testing is not carried out on set screws. Hardness, Decarburization & Torsional strength test are the requisite mechanical properties to be met by the alloy steel socket set screws.

The set screws will not have any marking.

3.0 Surface Finish:

Alloy Steel: Thermal Black Oxide Finish.



BRIGHTON-BEST INTERNATIONAL



P R O D U C T D A T A S H E E T

USA/CA: brightonBEST.com Europe: brightonBEST.org AU: brightonBEST.com.au NZ: brightonBEST.co.nz Brazil: brightonBEST.com.br

Hexagon Socket Set Screws Half Dog Point - Inch Series

1.0 Dimensions: ASME B18.3.

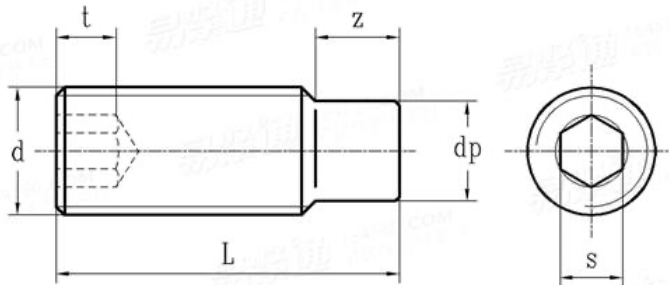

Nominal Size or Basic Product Diameter d	s	t	Half Dog Point Dimensions			
	Hexagon Socket Size	Key Engagement	Half Dog Point Diameter dp		Half Dog Point Length Z	
	Nom	Min	Max	Min	Max	Min
# 4	0.050	0.070	0.075	0.070	0.030	0.026
# 5	1/16	0.080	0.083	0.078	0.033	0.027
# 6	1/16	0.080	0.092	0.087	0.038	0.032
# 8	5/64	0.090	0.109	0.103	0.043	0.037
# 10	3/32	0.100	0.127	0.120	0.049	0.041
1/4	1/8	0.125	0.156	0.149	0.067	0.059
5/16	5/32	0.156	0.203	0.195	0.082	0.074
3/8	3/16	0.188	0.250	0.241	0.099	0.089
7/16	7/32	0.219	0.297	0.287	0.114	0.104
1/2	1/4	0.250	0.344	0.334	0.130	0.120
5/8	5/16	0.312	0.469	0.456	0.164	0.148
3/4	3/8	0.375	0.562	0.549	0.196	0.180

Notes: Thread Class of Fit: 3A.

Disclaimer: The above is a compilation of data, from various industry standards. BBI has taken every effort to present the data accurately. However BBI cannot be held liable for any claim traceable to any errors typographical or otherwise contained herein.



BRIGHTON-BEST INTERNATIONAL



P R O D U C T D A T A S H E E T

USA/CA: brightonBEST.com Europe: brightonBEST.org AU: brightonBEST.com.au NZ: brightonBEST.co.nz Brazil: brightonBEST.com.br

Hexagon Socket Set Screws Half Dog Point - Inch Series

2.0 Mechanical Properties:

Set screws are subjected to compressive stress in applications. Tensile testing is not carried out on set screws.

2.1 Alloy Steel

Standard: ASTM F912

Hardness: HRC 45 to 53.

Hardness, Decarburization & Torsional strength test are the requisite mechanical properties to be met by the alloy steel socket set screws.

2.2 Stainless Steel

Standard: ASTM F880

Condition: CW

Hardness: 96 HRB to 33 HRC.

Hardness and Torsional strength test are the requisite mechanical properties to be met by the stainless steel socket set screws. Set screws (Stainless steel only) of sizes above 1/2 " are not subjected to torsional strength test.

The set screws will not have any markings.

3.0 Surface Finish:

Alloy Steel: Thermal Black Oxide Finish.

Stainless Steel: Passivated.